

APP

NOTE: The gazebo is an IoT (Internet of Things) device. It must be connected to the internet via your Wi-Fi network.

PREPARATION FOR CONNECTION

1. Download and register the app

- Search APP "SUNS outdoor lifestyle" in Google Play Store or Apple App Store to download the app.
- Create a new account by entering your email and country of residence.
- Check your email account for the confirmation code and input it in the app.
- Set a password for your account. Please save and keep this information safe.
- Turn your Bluetooth on and give the permissions needed when you are asked to do so.

2. Create a reliable Wifi connection

- The gazebo exclusively supports the 2.4GHz frequency. Confirm that your router and Wi-Fi network are configured with a 2.4GHz signal. If uncertain or in need of assistance, refer to your router's documentation or consult with an IT specialist.
- Verify your Wi-Fi password and keep it accessible. This will be necessary during the gazebo pairing process.
- Make sure your phone is connected to the designated WiFi network for your gazebo.
- Ensure the gazebo is assembled in an area with a strong WiFi signal. Aim for a short distance between the router and the gazebo, avoiding obstacles such as walls. If your app control malfunctions, consider relocating the router or using a WiFi repeater.

Connecting Your Gazebo with the App

1. Click on "Add Device" in the middle of the screen
If you have already paired one product within the app click on the "+" plus button in the upper right corner and then on add device. (Ensure that your mobile device, running the app, is already connected to the intended WiFi before starting with this step.)

2. If your app lacks Bluetooth permission, please grant it now, as it is required. Once the app detects your gazebo, click on "Add" right next to it.

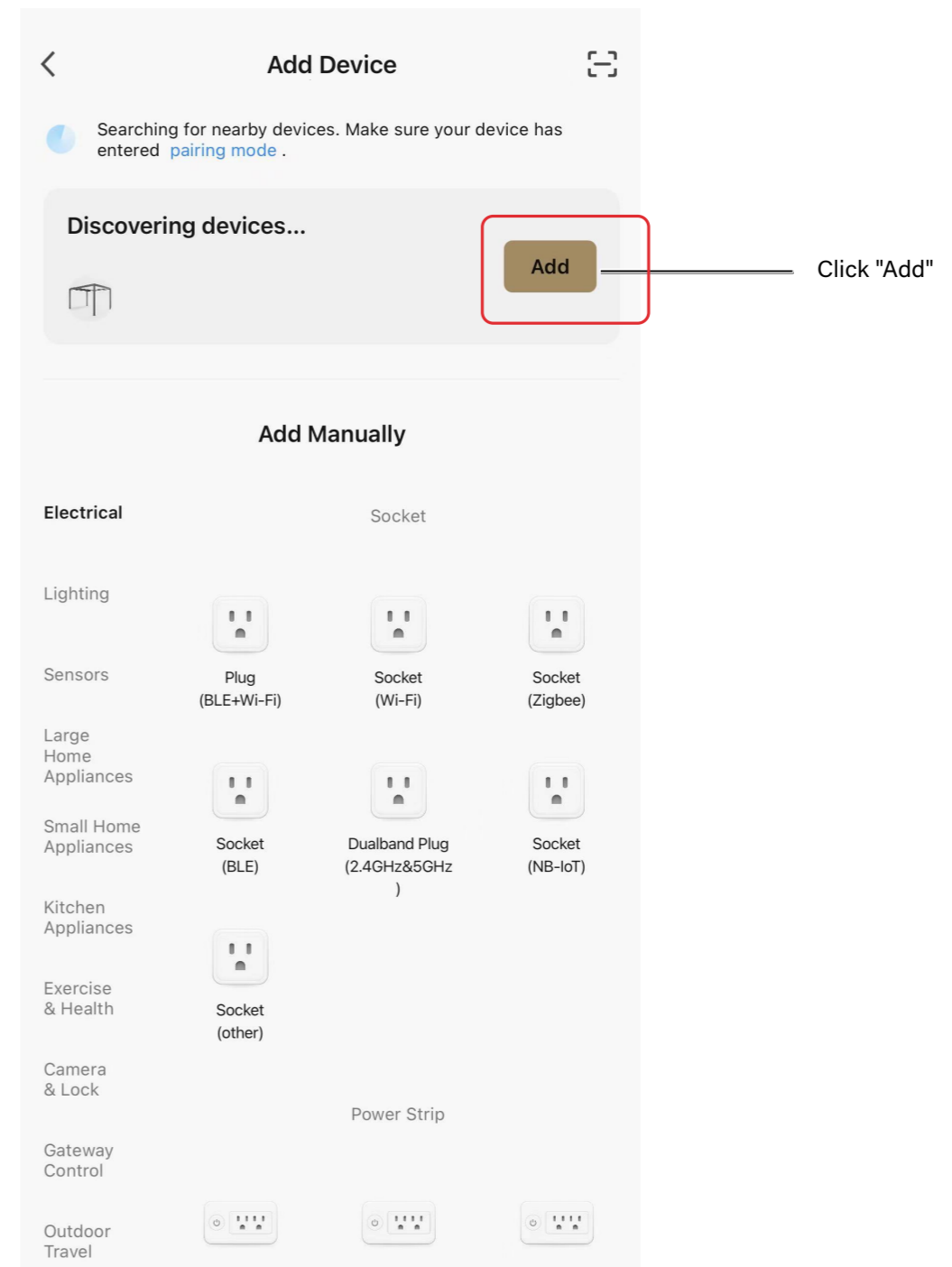
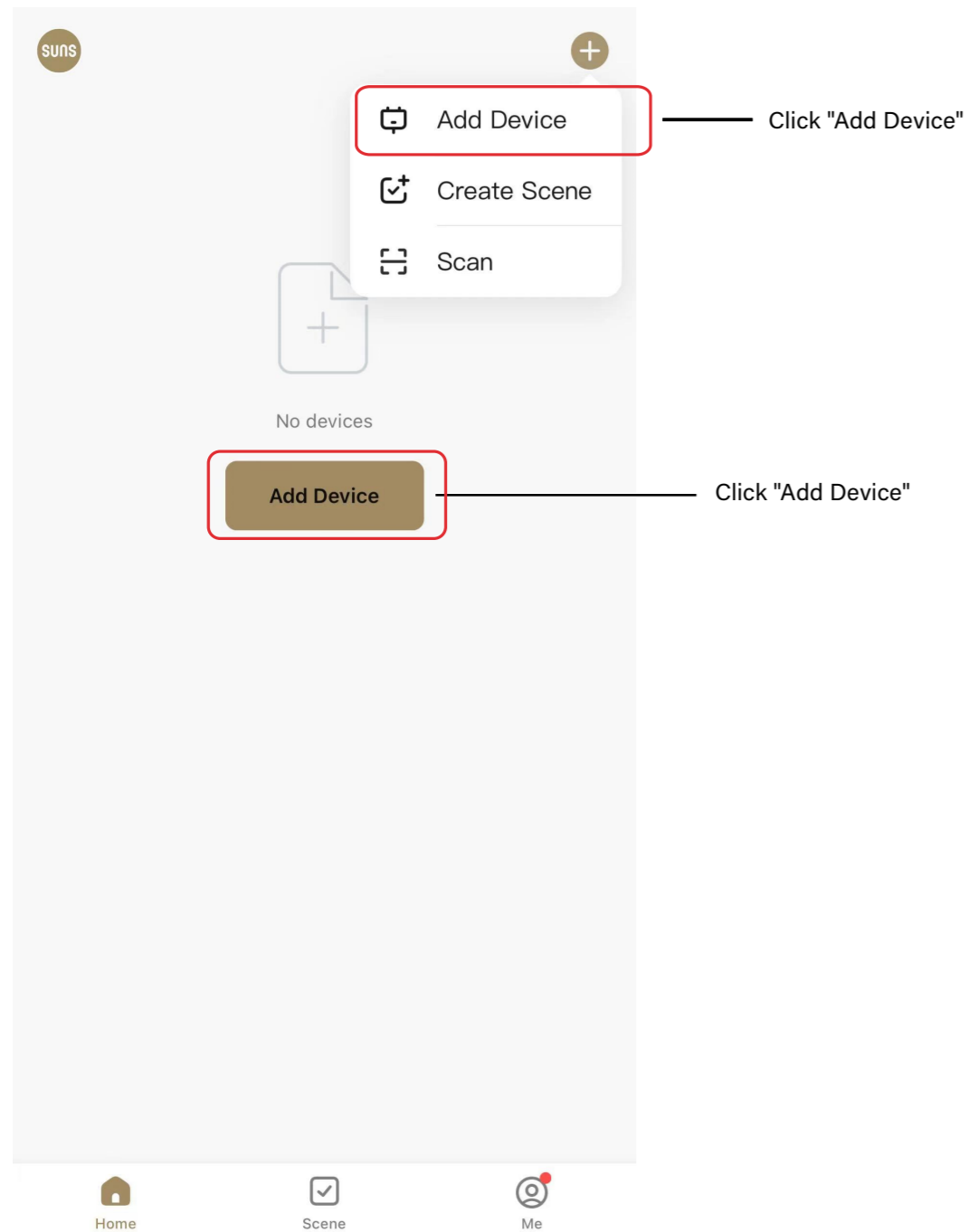

3. Check if the correct WiFi is selected and enter the password. Click "Next" to connect the gazebo to the selected WiFi.

Enter your WiFi networkname and password

Next

Click "Next"

4. Wait for the gazebo to be added. Once the connection is established, click "Done". If you encounter any issues, restart from the beginning.

Done

Click "Done"

Control Your Gazebo via App

1. Click on the device icon to enter the corresponding control interface.

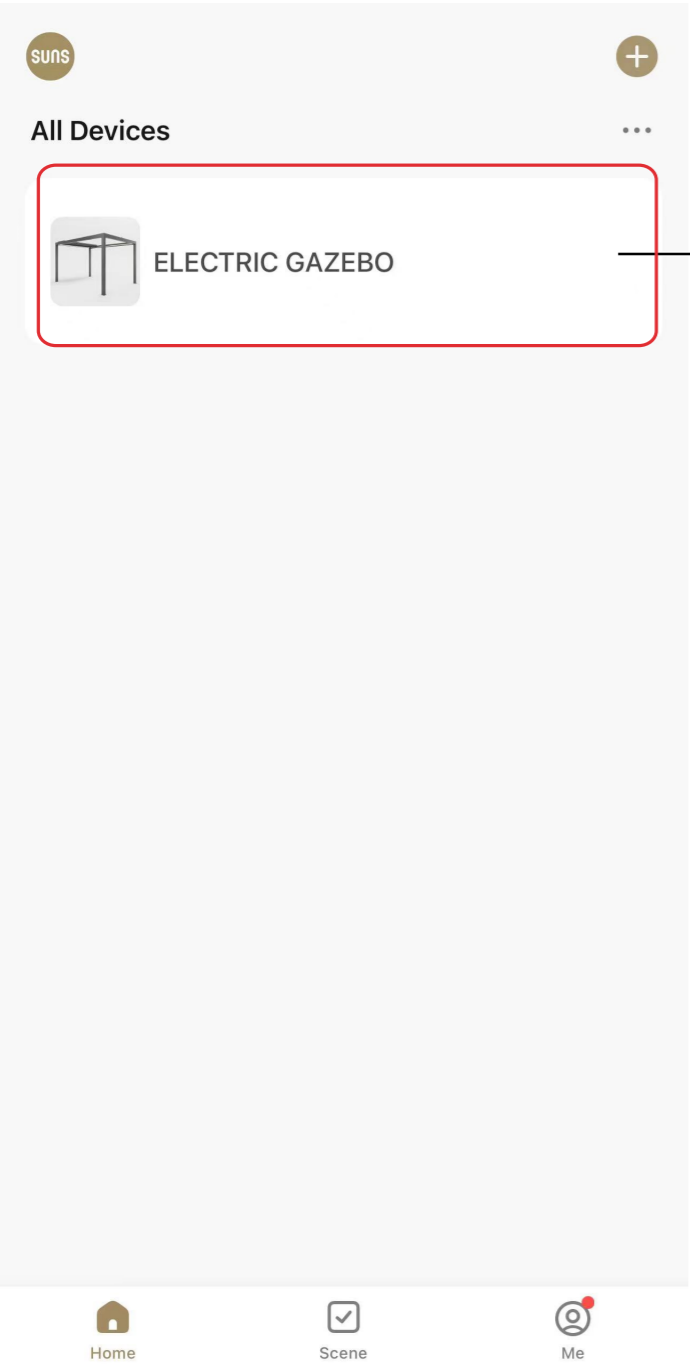

Click on the icon

2. Control your gazebo as described below.

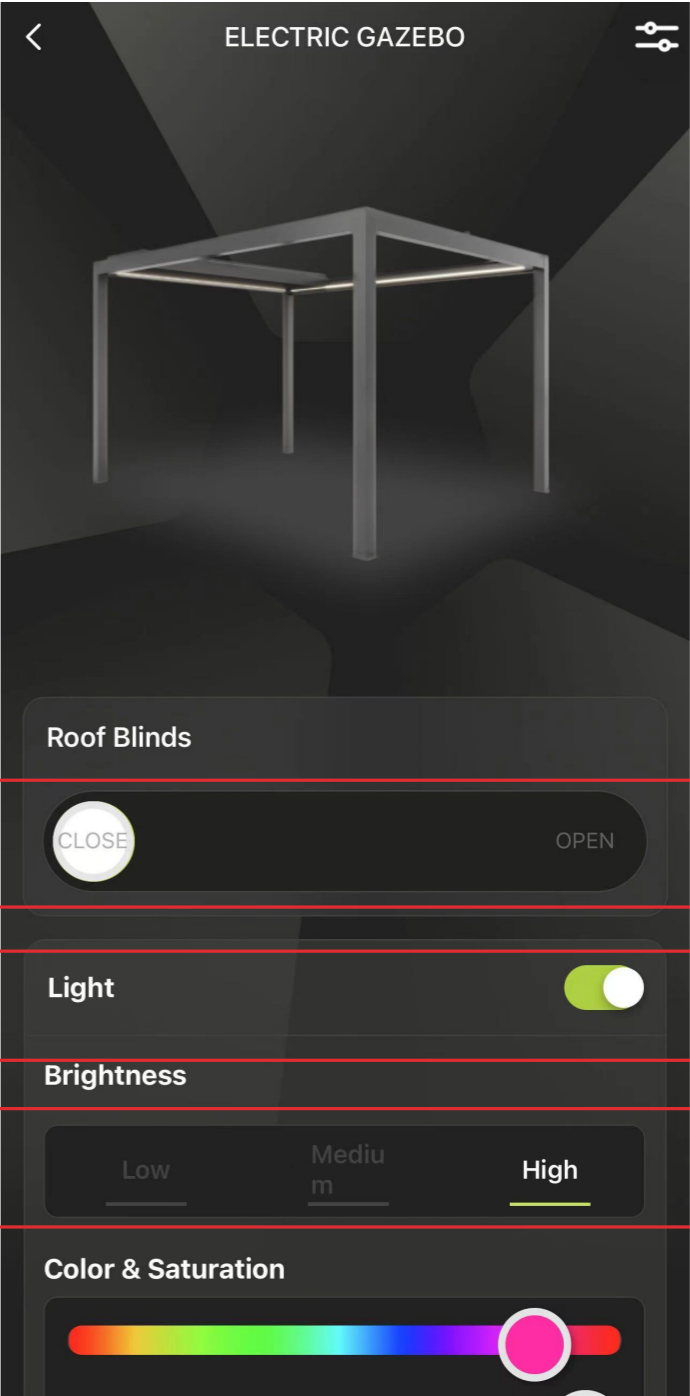

Drag the icon to open or close the louvers

Light switch

Light dimmer

3. Scroll down for more control options.

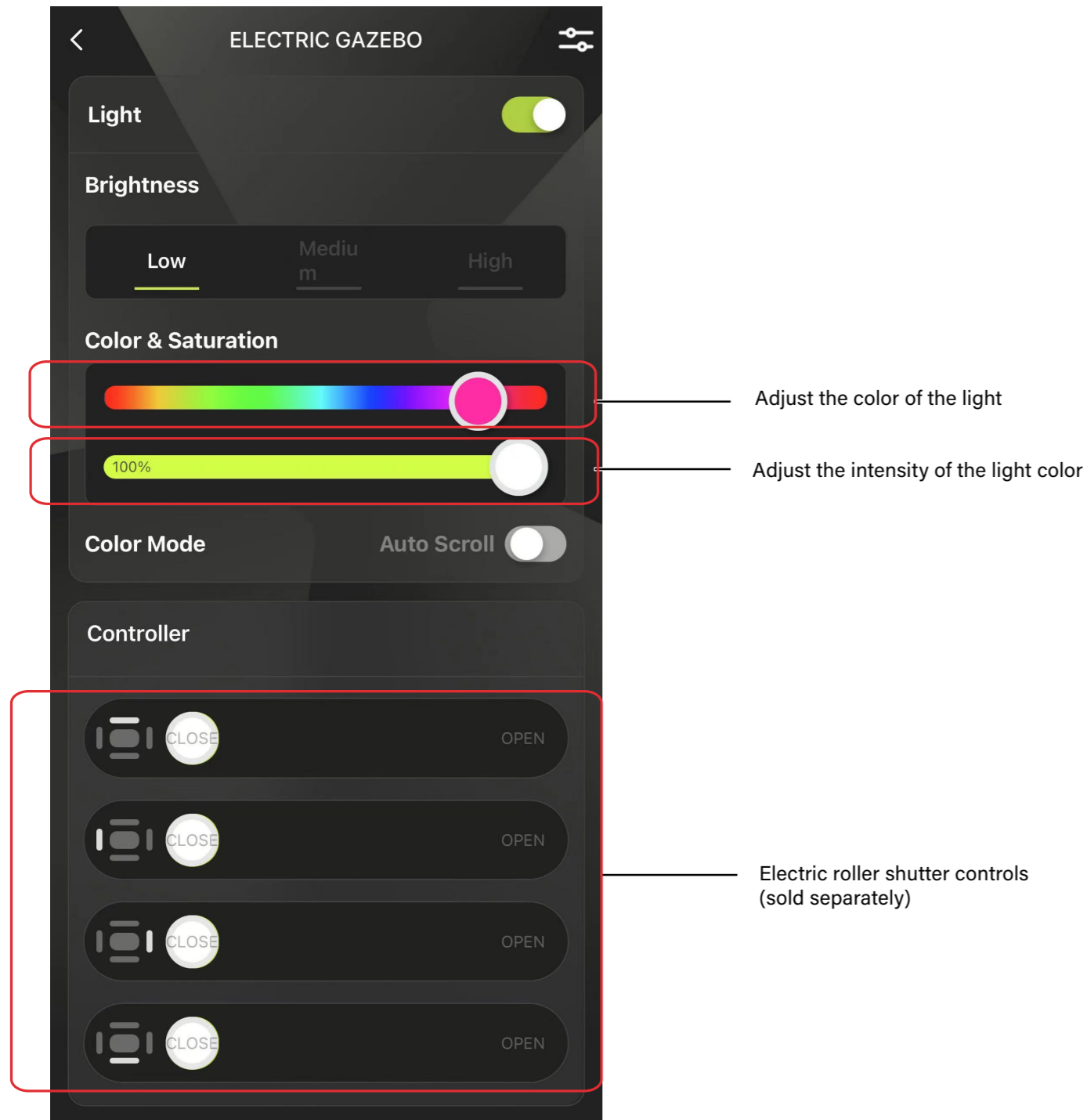

Remove not needed products from your App

1. Click in the upper right on the switch symbol of the product you want to delete. You can access the advanced configuration there.

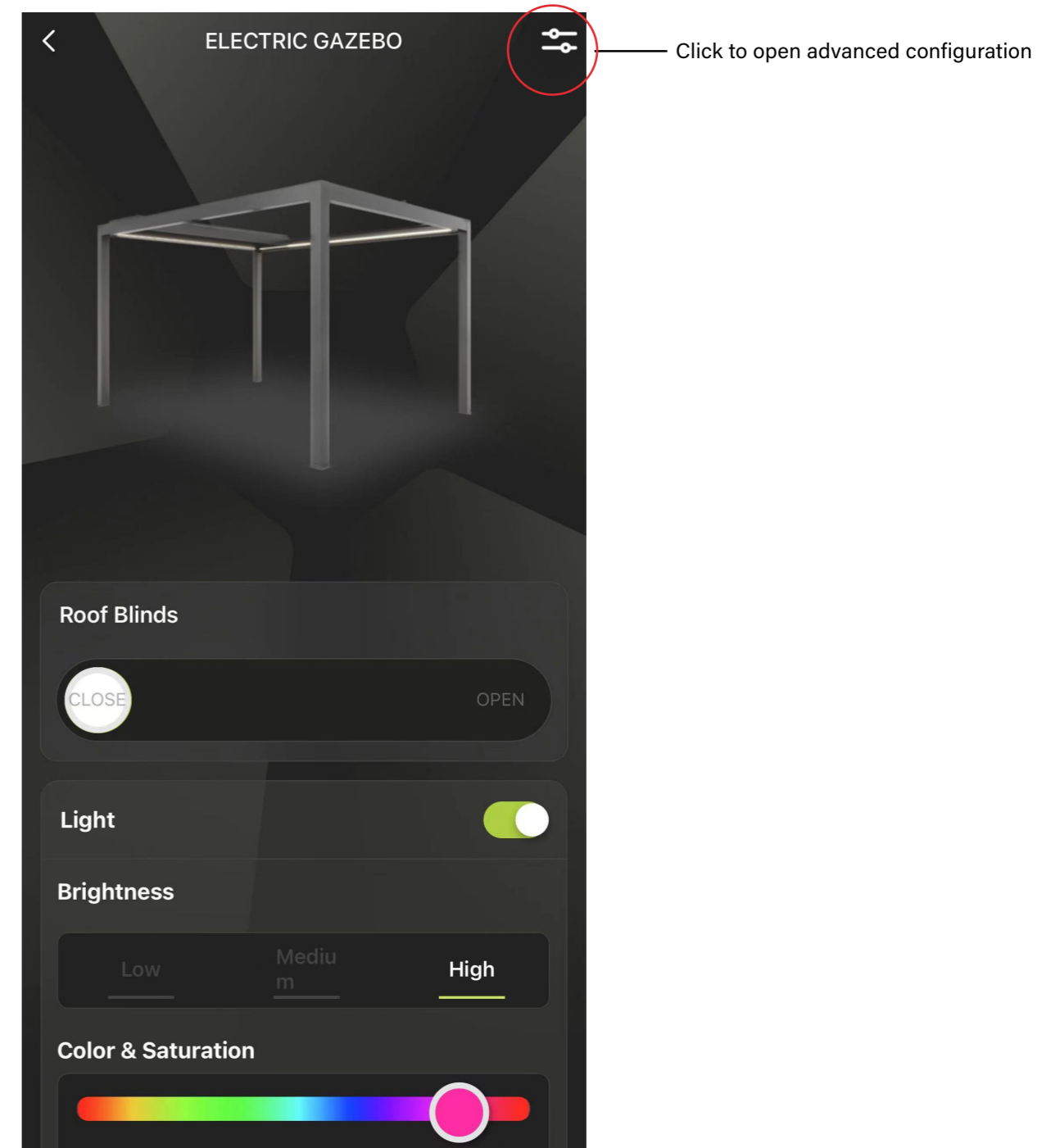

2. Click on "delete device" and confirm it by clicking on "Disconnect". "Disconnect and wipe data" will delete all configurations regarding this product.

3. Click on "Confirm" to complete the task.

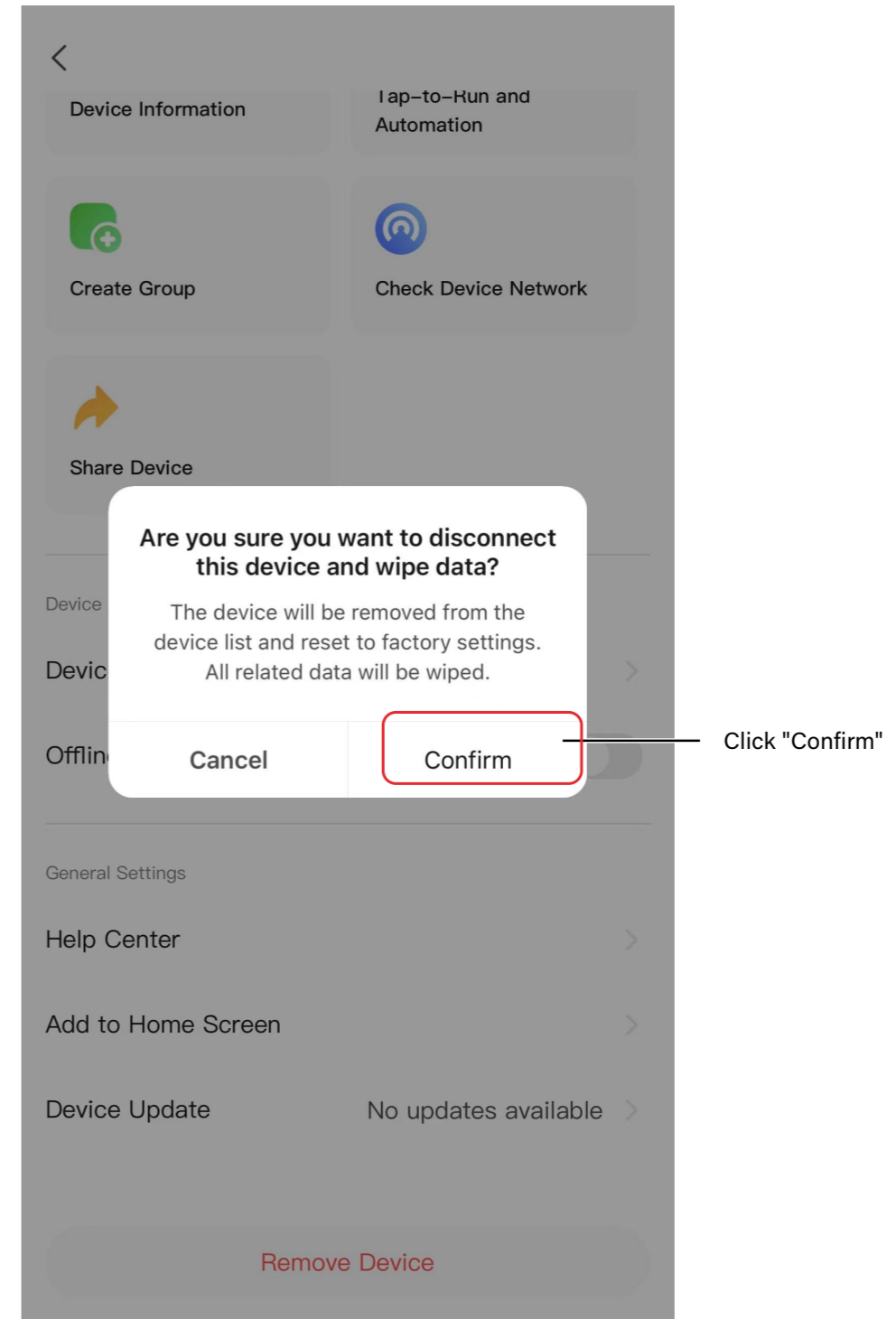
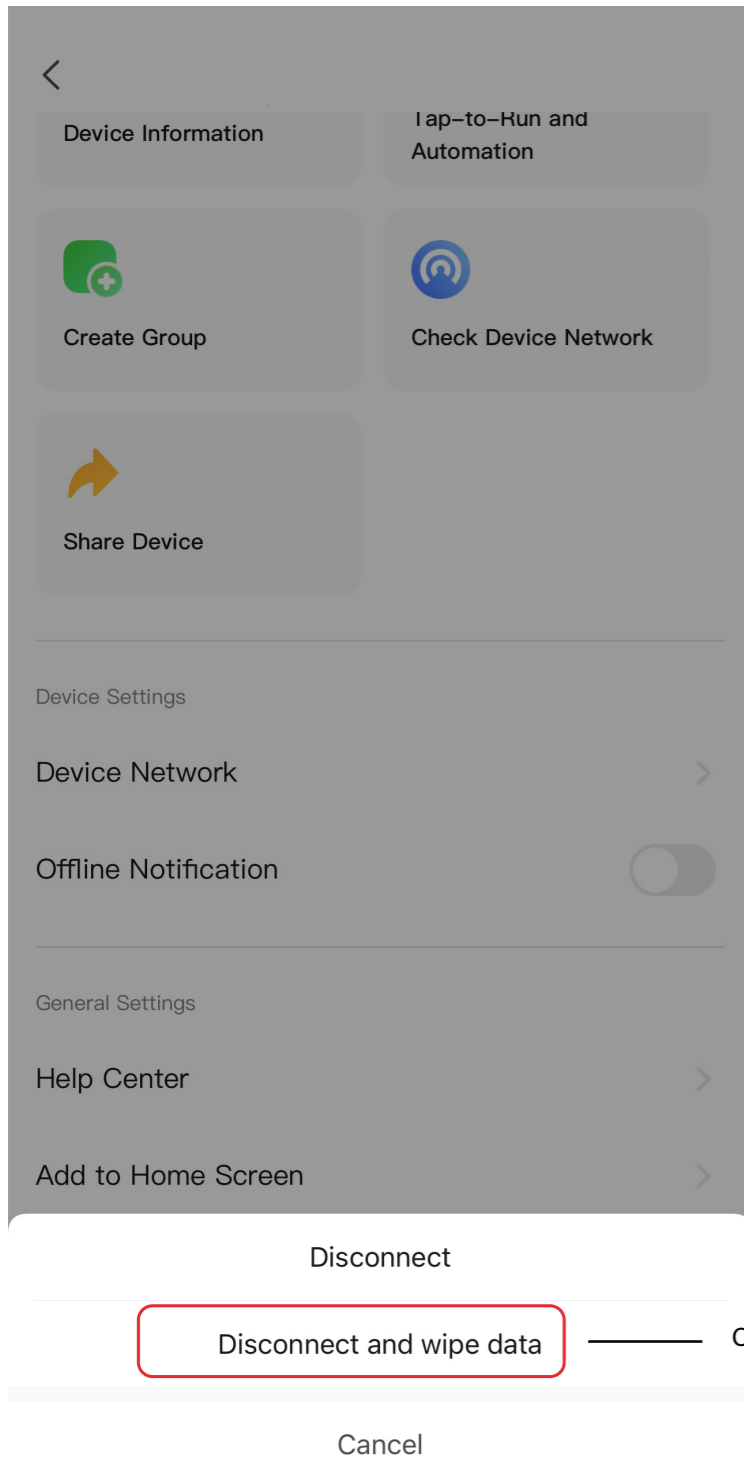

Delete the connection to the app via the power plug.

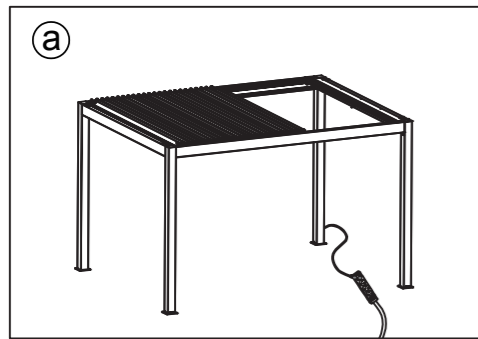

(a) Plug in the mains and wait for 1-3 seconds

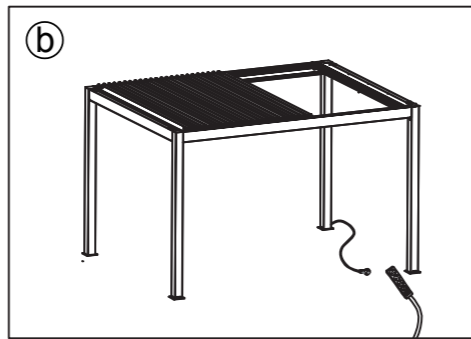

(b) Plug out the plug and wait for 5-10 seconds

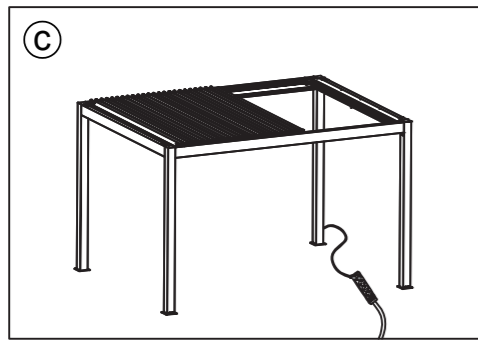

(c) Plug in again and wait for 1-3 seconds

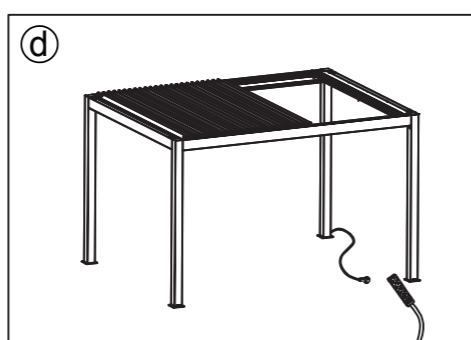

(d) Plug out the plug again and wait for 5-10 seconds

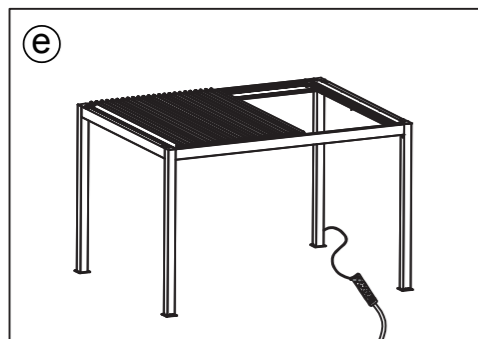

(e) Plug in the plug for the third and final time. The light blinks 5 times, indicating that the connection to the app has been successfully deleted.

Delete the connection to the app by relearning the remote control.

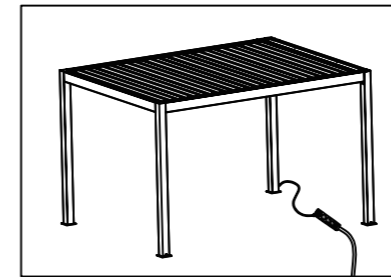

Plug the gazebo into the mains. The light will start blinking for 5 seconds.



Press button (1), (2), or (3) on the remote control, depending on the channel to which you have paired the Pavilion and wish to delete. Hold the button down while the light is blinking.

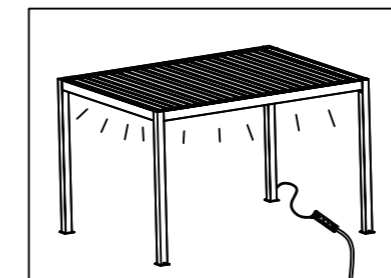

The light shines permanently, which means the deletion was successful. Release the button.

Create a homegroup and invite other users to control the gazebo

1. Click on "Me" and "Home Management"

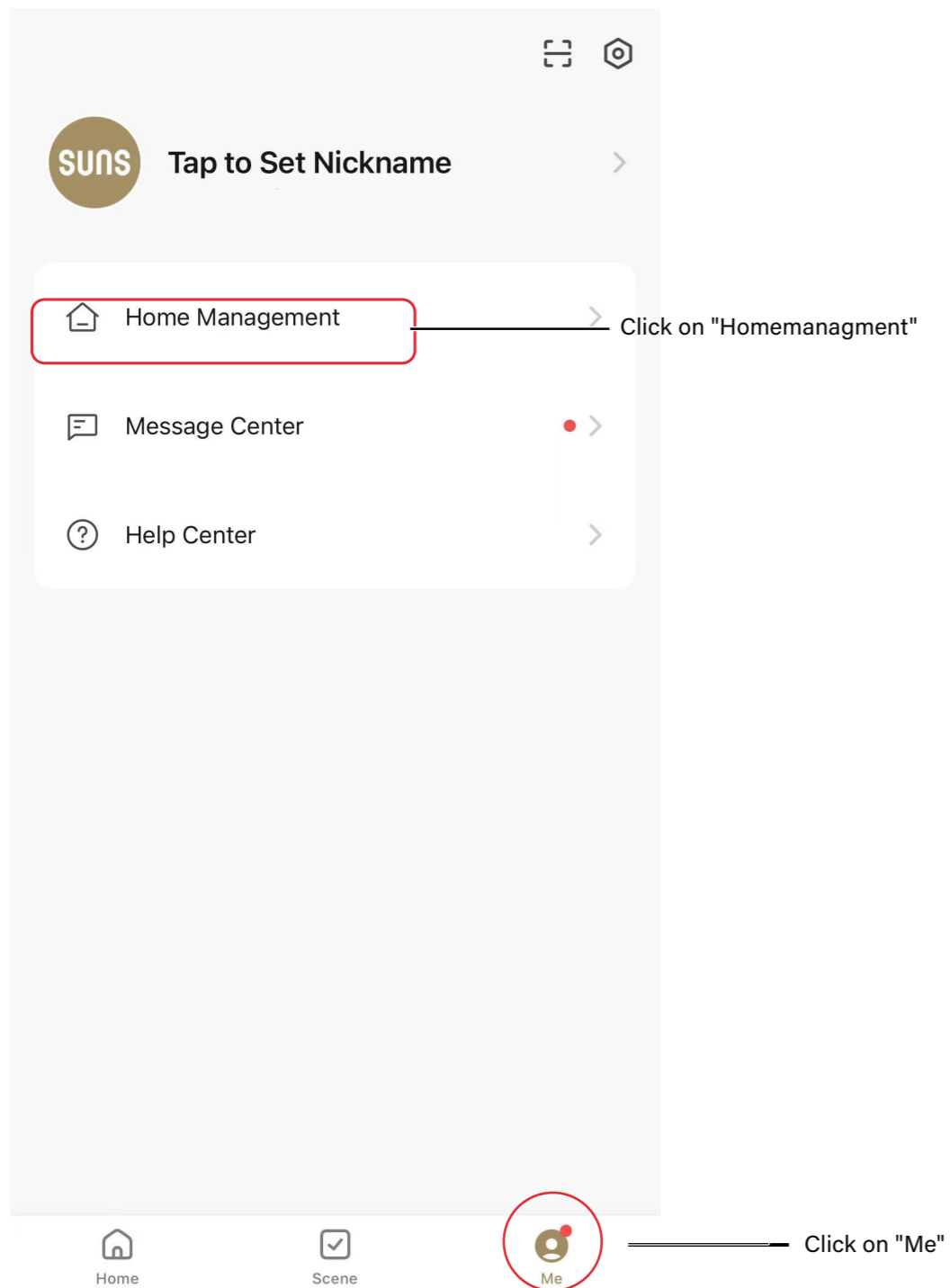

2. Create a new home by clicking on "my home" or "Create a home".

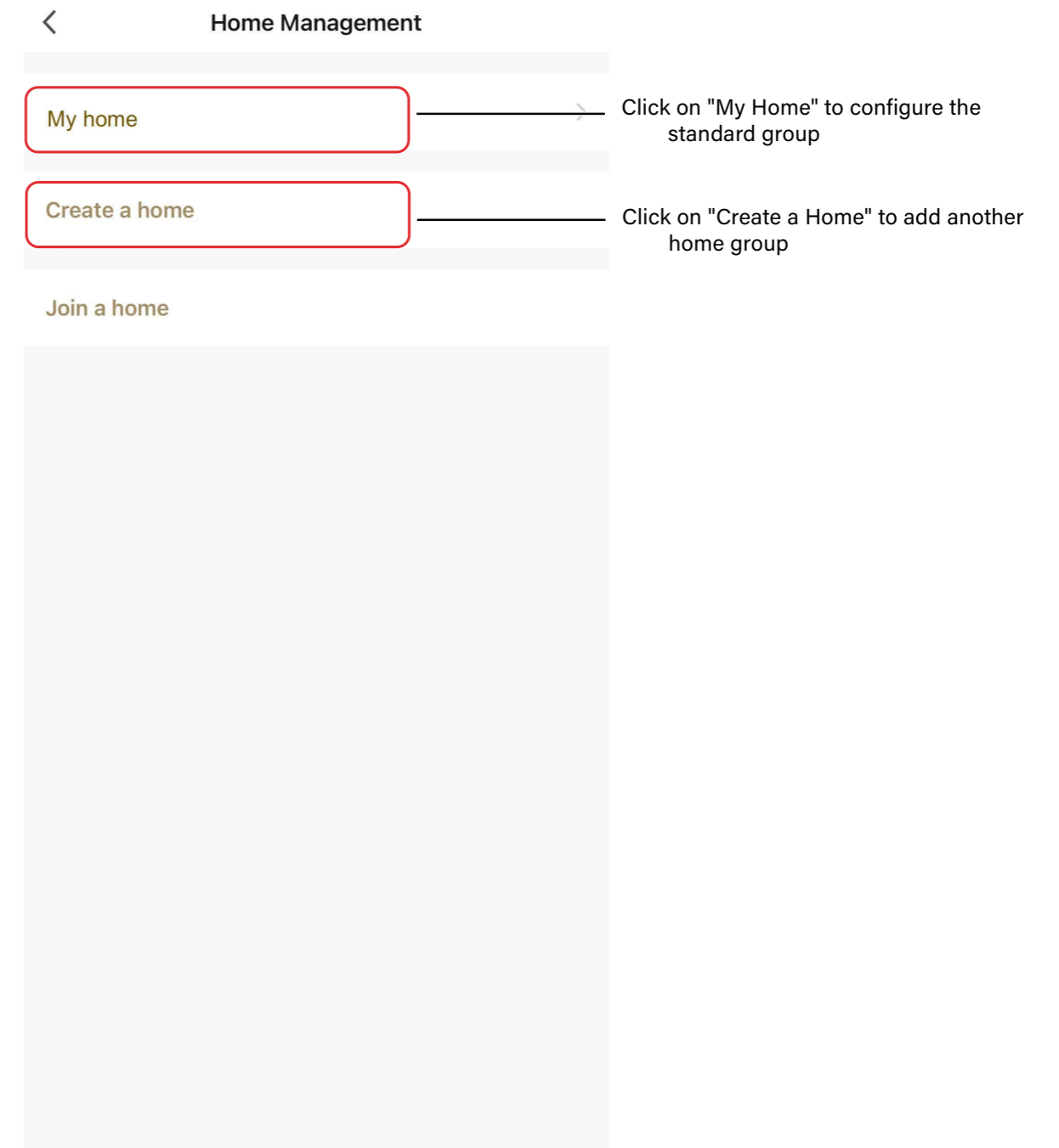

3. Give your home an easily memorable name and configure it according to your needs.
Click on "Save" when you are finished.

Cancel **Complete Home Information** Save

Home Name* Enter

Location Set >

Rooms:

- Living Room ✓
- Master Bedroom ✓
- Second Bedroom ✓
- Dining Room ✓
- Kitchen ✓
- Study Room ✓

Add Room

Click „Save“ after finishing configuration

Give your home a name

4. Click on your newly created home to configure it.
(you can rename rooms and add the pavilion to a room)

< **Home Management**

1

Create a home

Join a home

Click on your newly created home to configure it

5. Click on "Add member" to add more users to your home. You have different options to invite new people. Click on "More" to send invitations via Chat apps, email or Short message.

